

## A Fusion of "Core" Dispensing Technologies MUSASHI's motion units

SHOTMASTER 500SX-SS  
SHOTMASTER 400SX-SS  
SHOTMASTER 300SX-SS  
SHOT mini 200SX-SS  
SHOT mini 100SX-SS

«Ultimate cost-effective performance»

Newly  
Developed



CE  
RoHS



◆ 800 mm/s, highest level of operation speed in this class.

◆  $\pm 0.01$  mm repetitive positioning accuracy.

◆ **Newly developed** Synchro Speed function. PAT.P

The line width can be maintained at constant even when moving through a corner.  
Maximum reduction in cycle time for the highest production efficiency.

Fully enhanced operability

### New type teaching pendant

- Equipped with **interactive user-friendly interface**
- **Stopwatch function**
- **Dispensing condition switching function**
- **Data transfer function between robots**
- Available in **Japanese, English, and Chinese**



Multifunctional machine

### Substantial hardware configuration

- **External input/output: 26/26**
- **USB port**  
High-speed communication
- **"START" button, "STOP" button, "RETURN TO ORIGIN" button, "DISPENSE" button** equipped as standard
- **Z-axis brake function**

**Optional**

### Nozzle adjuster

**Automated nozzle position offset adjustment after syringe replacement.**



# Specifications

Item name	SHOTmini100SX	SHOTmini 200SX		SHOTMASTER 300SX		SHOTMASTER 400SX		SHOTMASTER 500SX	
Model	SM100SX-3A-SS	SM200SX-3A-SS-01	SM200SX-4A-SS	SM300SX-3A-SS	SM300SX-4A-SS	SM400SX-3A-SS	SM400SX-4A-SS	SM500SX-3A-SS	SM500SX-4A-SS
Number of axes controlled	3-axis		4-axis	3-axis	4-axis	3-axis	4-axis	3-axis	4-axis
Travel ranges	X, Y axes	100mm	200mm		300mm		400mm		500mm
	Z-axis	50mm		80mm		80mm		80mm	
	W-axis	-		±360°		-		±360°	
Setting range of PTP operation speed (*1)	X, Y axes	1 to 800mm/s		1 to 800mm/s		1 to 800mm/s		1 to 800mm/s	
	Z-axis	1 to 350mm/s		1 to 250mm/s		1 to 400mm/s		1 to 400mm/s	
	W-axis	-		1 to 900°/s		1 to 900°/s		1 to 900°/s	
Setting range of interpolation operation speed (*1)	X, Y axes	0.1 to 800mm/s		0.1 to 800mm/s		0.1 to 800mm/s		0.1 to 800mm/s	
	Z-axis	0.1 to 350mm/s		0.1 to 250mm/s		0.1 to 400mm/s		0.1 to 400mm/s	
	W-axis	-		0.1 to 900°/s		0.1 to 900°/s		0.1 to 900°/s	
Repetitive positioning accuracy (*2)	X, Y axes	±0.01mm		±0.01mm		±0.01mm		±0.01mm	
	Z-axis	-		±0.01°		±0.01°		±0.01°	
	W-axis	-		±0.01°		±0.01°		±0.01°	
Transportable weight (*3)	Y-axis	8kg		15kg		15kg		15kg	
	Z-axis	2kg	3.5kg	2.5kg	7kg	6kg	7kg	6kg	7kg
Rated voltage and frequency	AC100-240V 50/60Hz								
Power consumption	100W		120W	200W	220W	200W	220W	200W	220W
External dimensions (*4) (excluding protrusions)	W	202mm	302mm		510mm		610mm		710mm
	D	290mm	301mm		570mm		670mm		770mm
	H	440mm		555mm	590mm	690mm	590mm	690mm	590mm
Weight	11kg		13.3kg	15.5kg	37kg	40kg	55kg	58kg	66kg

## Common specifications

Control method (*5)	PTP control and interpolation control	
Interpolation	3-D line, 3-D circular arc/circle, 3-D elliptic arc/circle, spline	
Number of input/output signal points	General-purpose input	26 points
	General-purpose output	26 points
Program entry method	Teaching pendant, PC	
Language	Japanese, English, Chinese	
Program capacity (*6)	40000 steps (999 channels)	
Program storage system	Internal	Internal memory
	External	Backup on PC with dispensing pattern editing software
Program editing software	MuCADV (optional)	

## External dimensions

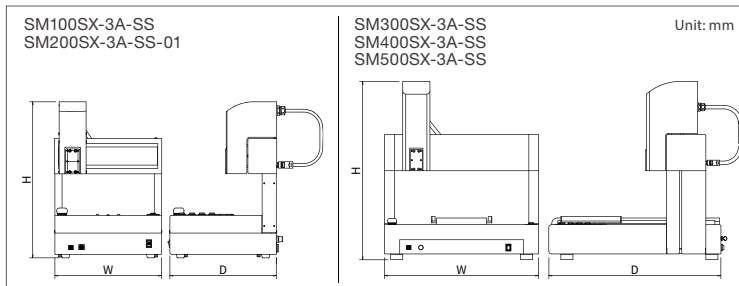

- \*1 These values vary depending on the operations, the weight and gravity center of the loaded object, or other factors.  
 \*2 This valve is measured by the method prescribed by Musashi (measuring method in conformity with JIS).  
 \*3 When options are not mounted. The value varies with setting speed, setting acceleration/deceleration time, and operations.  
 \*4 W and D are the dimensions of the lower section of the case.  
 \*5 PTP control: This is control for each specified axis to move to the end coordinates at each speed.  
 Interpolation control: This is control for each specified axis to move to the end coordinates at the total interpolated speed.  
 \*6 Main routine: 1 to 99 CH, Sub routine: 100 to 999 CH.

NEW



SHOTmini 100SX



SHOTmini 200SX



SHOTMASTER 300SX



SHOTMASTER 400SX

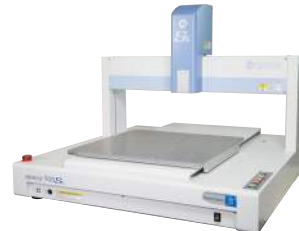

SHOTMASTER 500SX

- Raised specifications are also available as standard lineup.

## 4-axis specification robot

- Compatible with SHOTmini 200SX and SHOTMASTER 300/400/500SX.



Dispense head  
Rotation specifications



Work rotation  
specifications(custom)



## Dispensing pattern editing software MuCADV

### No.1 dispensing know-how included!

- Intuitive drawing program
- Easy editing for beginners
- Supports program transfer from standard type (such as Ω/DS series)

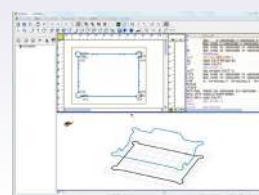

World Leading Dispenser  
MUSASHI ENGINEERING, INC.

SINGAPORE 10 Ubi Crescent #05-24 Ubi Techpark Lobby B Singapore 408564  
TEL : (65)6258-2422 / FAX : (65)6258-4844

HEAD OFFICE 8-7-4, Shimorenjaku, Mitaka, Tokyo, 181-0013, Japan TEL:(81)422-76-7111 FAX:(81)422-76-7122

<http://www.musashi-engineering.co.jp/english/>

CAT.No.SXSERIES-10219-E-COPY

JIS Ind. pin. 3 and 4-pin. 50V

MUSASHI ENGINEERING, INC.  
JAPAN  
TEL: (81) 422-76-7111  
FAX: (81) 422-76-7122  
E-MAIL: musashi@musashi-eng.co.jp  
WEB: www.musashi-engineering.co.jp